

About the Guide

- This quick start guide is for reference only. Minor difference might be found in user interface.
- All the design and software here are subject to change without prior written notice.
- All trademarks and registered trademarks mentioned are the properties of their respective owners.
- Please visit our website or contact your local service engineer for more information.
- If there is any uncertainty or controversy, please refer to our final explanation.

Step 3

Power up the camera.

Step 4

Add a camera to Imou Life App

On the **Device** interface, tap + on the upper-right corner, scan the QR code on the bottom of the camera or enter the serial number, and do the operations as the screen instruction.

Note: If you have more than one camera, do step 4 to add them one by one.

Installing Camera

Note: Make sure that the mounting surface is strong enough to hold at least three times of the camera weight.

Ceiling Mount

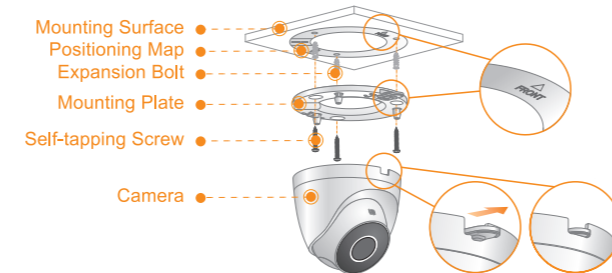

Step 1 Drill screw holes on the mounting surface as the positioning map shows, and then put in the expansion bolts.

Step 2 Attach the mounting plate to the mounting surface with the self-tapping screws.

Step 3 Push the camera to attach it to the mounting plate, power it up, and then adjust the lens to the ideal angle.

Wall Mount

- For the installing procedures, see the steps in “Ceiling Mount.”
- Make the UP arrow on the positioning map and mounting plate upward.

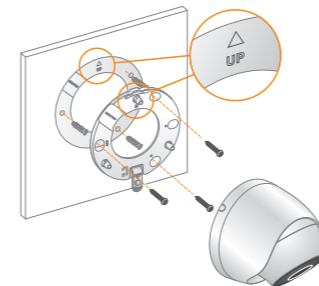

Adjusting Angle

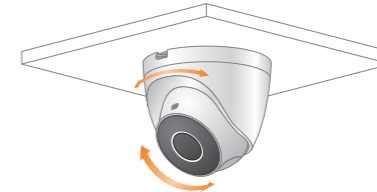

FAQ

► **Q: The camera cannot work normally or start?**

Make sure that the network cable is connected well, and the NVR or switch supports PoE power supply. When the indicator light on the NVR or switch flashes, it means that the camera is powered up.

► **Q: Where are the recorded videos saved?**

- Scene 1
Recorded videos are saved in NVR.
- Scene 2
When the Imou cloud is enabled, recorded videos are saved in Imou cloud.

► **Q: The IR effect is not good?**

The infrared light is reflected to the lens, so the effect is not good. Adjust the lens angle to avoid occlusions around the lens.

Imou

Quick Start Guide

Version 1.0.0

T2.00XXXXXX

Packing List



Camera ×1

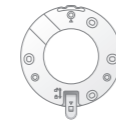

Mounting Plate ×1

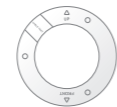

Positioning Map ×1



Screw Package ×1



QSG ×1

Camera Introduction

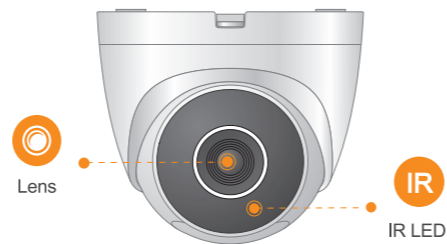

Lens

IR LED

Application

Scene 1

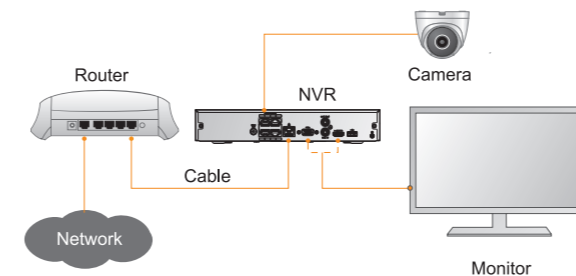

Scene 2

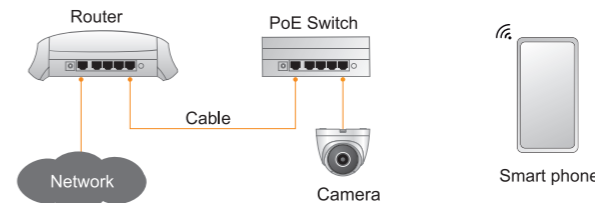

Operating with Imou Life App

Step 1

Scan the following QR code or search "Imou Life" in Google Play or App Store to download and install the app.

Note: If you have installed the app, update it to the latest version.



Step 2

Run Imou Life App, and then register an account for the first use.